

Department of Engineering  
Tim Bryan, P.E., PTOE, County Engineer

3137 South Liberty Street, Canton, MS 39046  
Office (601) 855-5582 FAX (601) 859-5857

**MEMORANDUM**

January 2, 2024

To: Casey Brannon, Supervisor, District I  
Trey Baxter, Supervisor, District II  
Gerald Steen, Supervisor, District III  
Karl Banks, Supervisor, District IV  
Paul Griffin, Supervisor, District V

From: Tim Bryan, P.E., PTOE  
County Engineer

Re: Comcast Utility Permit  
County Road Name, Camden Lake Circle

The Engineering Department recommends approval of the permit application for Comcast to place new fiber in conduit and new peds along and across Camden Lake Circle and county roads listed below:

- Camden Lake Drive
- Lake Cove
- Lake Bend
- Lake Vista Court

Revised: 2/14/2019



## PERMIT APPLICATION FOR THE CONSTRUCTION OR ADJUSTMENT OF A UTILITY WITHIN COUNTY ROAD RIGHT-OF-WAY

Utility Information: Utility Name: COMCAST

Address: 121 Marketridge Dr City/State/Zip: Ridgeland, MS 39157

Contact Person: KENNETH GOSS Contact's Phone: 601-862-4834

Project Information: County Road Name: CAMDEN LAKE CIR

(If located within more than one road right-of-way, use Appendix 1 for additional descriptions)

Beginning Location: 32.538099-90.171630 Ending Location: 32.539463-90.173904

Length of Project: 1958 Section: 14 Township: 8N Range: 1E

Description of Work: COMCAST TO BORE 2" CONDUIT AND PLACE PEDESTALS ALONG CAMDEN LAKE SUBDIVISION. SEE MAPS ATTACHED FOR EXACT LOCATIONS.

Check Box if Appendix 1 is to be included as a part of this Application

Whereas the above stated Utility makes application to the **Madison County Board of Supervisors** for a Construction Permit. Attached hereto are drawings and plans for the construction of the above facilities located within Madison County owned public rights-of-way. Once stamped by the Madison County Engineering Department, these plans shall not be changed or altered without written approval of the County Engineer, or his representative. A copy of the approved permit and plans shall be on-site at all times during construction.

The Applicant Utility shall comply with all policies, procedures and construction practices as outlined in *A Policy for The Accommodation of Utility Facilities within the Right-of-Way of all Public County Roads* (hereinafter referred to as the "Policy"), as adopted on November 1, 2005, by the **Madison County Board of Supervisors**, and which is hereby made a part of this Application Agreement.

If facilities are to be located within the Rights-of-Way of the County-Federal or State Aid System, Applicant Utility also agrees to comply with applicable provisions of *S.O.P. No. SA II-2-8, Accommodation of Utilities on Rights-of-Way*, issued by the State Aid Engineer and dated July 1, 2005.

The Applicant Utility understands and agrees that, except as herein granted, no right, title, claim, or easement to said road right-of-way is granted by the issuance of this permit. If this Utility is listed in the general provisions of the Policy, it will be adjusted to comply with same without cost to the County, unless the variance from the Policy has been approved by the granting of the Permit pursuant to this Application.

The Applicant Utility further understands that the Utility's engineering, plant, or other personnel will be responsible for the staking and construction supervision of the work set out above and as shown on the attached plans. If work impacts traffic in any way, the appropriate traffic control shall be installed per the *Manual of Uniform Traffic Control Devices*, Latest Edition.

The Applicant Utility understands that the County Engineer, or his representative, may issue a Stop Work Order at any time if it is deemed that site conditions are not suitable for construction or if any of the requirements of this permit are not being met.

Many County Roads have variable Rights-of-Way and/or no Right-of-Way at all and are maintained under a Prescriptive Easement. It is the sole responsibility of the Applicant Utility to verify the existence and limits of public rights-of-way. If none exists, it is the

responsibility of the Applicant Utility to acquire an easement for their Facilities from the applicable property owner(s). Madison County in no way verifies the limits of Right-of-Way as shown on the permit application.

The Applicant Utility shall be responsible for all future maintenance and repair of the facilities installed under this permit. The Applicant Utility shall make future adjustments to, or relocate, the facilities located within road or highway right-of-way when required for road or highway widening or other road or highway construction at no cost to Madison County. The Applicant Utility shall relocate said utilities within sixty (60) days of notification by County by registered mail, return receipt requested, unless otherwise designated by the County Engineer. Further, any maintenance, repair, or construction shall be done in such a manner as to occasion no unreasonable interference with the normal flow and safety to traffic and at the expense of the utility company. When reasonable care has been taken to locate said utility facilities within the right-of-way, the Applicant Utility understands that any damages caused by routine maintenance and construction by County forces shall be borne by the Applicant Utility.

The Applicant Utility further agrees to indemnify and hold Madison County harmless for any and all claims, accidents, damages, liabilities and expenses occasioned wholly, or in part, by any act or omission of applicant, its agents or employees. In case County shall, without fault on its own part, be made a party to any litigation commenced by or against applicant, then applicant shall protect and hold County harmless, and shall pay all costs, expenses and reasonable attorney's fees incurred or paid by County in connection with said litigation.

All underground facilities shall be installed at a depth equal to or greater than 48" below the lowest adjacent grade.

All pipes carrying liquid shall be encased under County maintained roads.

WITNESS the signature of the Applicant this the \_\_\_\_\_ day of \_\_\_\_\_, 20\_\_\_\_\_.

By: \_\_\_\_\_  
(Applicant Signature)

Title: \_\_\_\_\_

**Note:** *Applicant must be an employee of the Utility named in this application. The Madison County Board of Supervisors will not recognize a Contractor, Subcontractor, Agent, or Consulting Engineer as the Applicant. Utility Company shall be fully responsible for all work performed under this application.*

I, or my authorized representative, have reviewed this application and determined that the drawing, sketches, and plans submitted by the Applicant meet the requirements of *A Policy for The Accommodation of Utility Facilities within the Right-of-Way of all Public County Roads.*

**APPROVED**  
By: **By timothy.bryan at 2:44 pm, Jan 10, 2024**

Tim Bryan, P.E.  
County Engineer

AGREED TO AND APPROVED BY:

\_\_\_\_\_  
Madison County Board President

Date: \_\_\_\_\_

ENTERED INTO THE MINUTES OF THE BOARD OF SUPERVISORS OF MADISON COUNTY, MISSISSIPPI ON THIS

\_\_\_\_\_ DAY OF \_\_\_\_\_, 20\_\_\_\_\_.

## Appendix 1

County Road Name: CAMDEN LAKE DR  
Beginning Location: 32.538001, -90.171433 Ending Location: 32.542857, -90.173581  
Length of Project: 4933' Section: 14 Township: 8N Range: 1E  
Description of Work: PLACE 4933' OF 2" CONDUIT AND PLACE PEDESTALS ALONG CAMDEN LAKE DR. SEE MAPS FOR EXACT LOCATIONS

County Road Name: LAKE CV  
Beginning Location: 32.539720, -90.172301 Ending Location: 32.539891, -90.171876  
Length of Project: 235' Section: 14 Township: 8N Range: 1E  
Description of Work: PLACE 235' OF 2" CONDUIT AND PLACE PEDESTALS ALONG LAKE CV. SEE MAPS FOR EXACT LOCATIONS.

County Road Name: LAKE BND  
Beginning Location: 32.540841, -90.174054 Ending Location: 32.541038, -90.173486  
Length of Project: 1316' Section: 14 Township: 8N Range: 1E  
Description of Work: PLACE 1316' OF 2" CONDUIT AND PLACE PEDESTALS ALONG LAKE BND. SEE MAPS FOR EXACT LOCATIONS.

County Road Name: LAKE VISTA CT  
Beginning Location: 32.538257, -90.173134 Ending Location: 32.538772, -90.172856  
Length of Project: 349' Section: 14 Township: 8N Range: 1E  
Description of Work: PLACE 349' OF 2" CONDUIT AND PLACE PEDESTALS ALONG LAKE CV. SEE MAPS FOR EXACT LOCATIONS.

County Road Name: \_\_\_\_\_  
Beginning Location: \_\_\_\_\_ Ending Location: \_\_\_\_\_  
Length of Project: \_\_\_\_\_ Section: \_\_\_\_\_ Township: \_\_\_\_\_ Range: \_\_\_\_\_  
Description of Work: \_\_\_\_\_



PREPARED BY:  
 NWA COMMUNICATIONS  
 5553 HWY 145  
 SHANNON, MS 38868  
 LANE WATTS / 662-687-1044  
 lwatts@nwautilities.com  
 permits@nwautilities.com  
  
 SUBMITTED ON BEHALF OF:  
 COMCAST COMMUNICATIONS  
 121 Marketridge Dr Ridgeland, MS 39157  
 KENNETH GOSS / 601-862-4834  
 kenneth\_goss@comcast.com

ENGINEERED BY:  
 PERMITS@NWAUTILITIES.COM



ENGINEERED FOR:



DISCLAIMER

THESE DRAWINGS AND SPECIFICATIONS  
 BEING ISSUED IN STRICT  
 CONFIDENCE AND SHALL NOT BE  
 REPRODUCED,  
 COPIED, OR USED FOR ANY PURPOSE  
 WITHOUT SPECIFIC WRITTEN PERMISSION

PROJECT TOTAL FOOTAGES

NEW AERIAL BUILD  
 0'  
  
 NEW OVERLASH  
 0  
  
 NEW BURIED  
 8799'

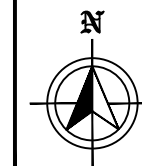

MATERIAL LIST

DESCRIPTION	QUANTITY

PROJECT IDENTIFICATION

JB #: JB0001399337  
 ADDRESS: 102 CAMDEN LAKE CIR  
 CITY, STATE, ZIP: MADISON MS 39110  
 COUNTY: MADISON  
 DATE: 12/19/23  
 REVISION: 0

# LEGEND

ENGINEERED BY:  
PERMITS@NWAUTILITIES.COM



ENGINEERED FOR:



### DISCLAIMER

THESE DRAWINGS AND SPECIFICATIONS BEING ISSUED IN STRICT CONFIDENCE AND SHALL NOT BE REPRODUCED, COPIED, OR USED FOR ANY PURPOSE WITHOUT SPECIFIC WRITTEN PERMISSION

### PROJECT TOTAL FOOTAGES

NEW AERIAL BUILD  
0'  
NEW OVERLASH  
0'  
NEW BURIED  
8799'



### MATERIAL LIST

DESCRIPTION	QUANTITY

### PROJECT IDENTIFICATION

JB #: JB0001399337  
ADDRESS: 102 CAMDEN LAKE CIR  
CITY, STATE, ZIP: MADISON MS 39110  
COUNTY: MADISON  
DATE: 12/19/23  
REVISION: 0

## LINE TYPES

	PROPOSED UNDERGROUND
	PROPOSED AERIAL
	EXISTING CONDUIT
	EDGE OF TRAVEL
	CENTERLINE
	LANE DIVIDER
	RIGHT OF WAY
	DRIVEWAY
	FENCE LINE
	PROPERTY LINE
	SIDEWALK
	RAILROAD
	WATER
	SEWER
	GAS
	STORM DRAIN
	TELECOMMUNICATIONS
	POWER
	UNKNOWN UTILITY

## ABBREVIATIONS

EOP	EDGE OF PAVEMENT
R/W	RIGHT OF WAY
R	RISER
SD	STORM DRAIN
S/W	SIDEWALK
HDPE	HIGH DENSITY POLYETHYLENE
STA.	STATION NUMBER
TELCO	TELECOMMUNICATIONS
HH	HANDHOLE
D/W	DRIVEWAY
CONC.	CONCRETE
F/O	FIBER OPTIC
EC	EXISTING CONDUIT

## SYMBOLS

	PROPOSED PEDESTAL WITH SILT FENCE		BRIDGE RAIL		ADA RAMP
	PROPOSED VAULT WITH SILT FENCE		PROPOSED ANCHOR		NORTH ARROW
	PROPOSED BOREHOLE WITH SILT FENCE		EXISTING ANCHOR		FIRE HYDRANT
	EXISTING PEDESTAL		STORM DRAIN SYMBOLS		
	EXISTING VAULT		STORM DRAIN SYMBOLS		
	EXISTING TRANSFORMER				
	EXISTING TELECOMMUNICATIONS				
	EXISTING POWER POLE				
	EXISTING MANHOLE				
	WATER VAULT				
	RISER				



ENGINEERED FOR:

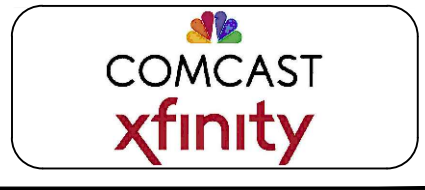

DISCLAIMER

THESE DRAWINGS AND SPECIFICATIONS BEING ISSUED IN STRICT CONFIDENCE AND SHALL NOT BE REPRODUCED, COPIED, OR USED FOR ANY PURPOSE WITHOUT SPECIFIC WRITTEN PERMISSION

PROJECT TOTAL FOOTAGES

- NEW AERIAL BUILD 0'
- NEW OVERLASH 0'
- NEW BURIED 8799'



MATERIAL LIST

DESCRIPTION	QUANTITY

PROJECT IDENTIFICATION

JB #: JB0001399337  
ADDRESS: 102 CAMDEN LAKE CIR  
CITY, STATE, ZIP: MADISON MS 39110  
COUNTY: MADISON  
DATE: 12/19/23  
REVISION: 0

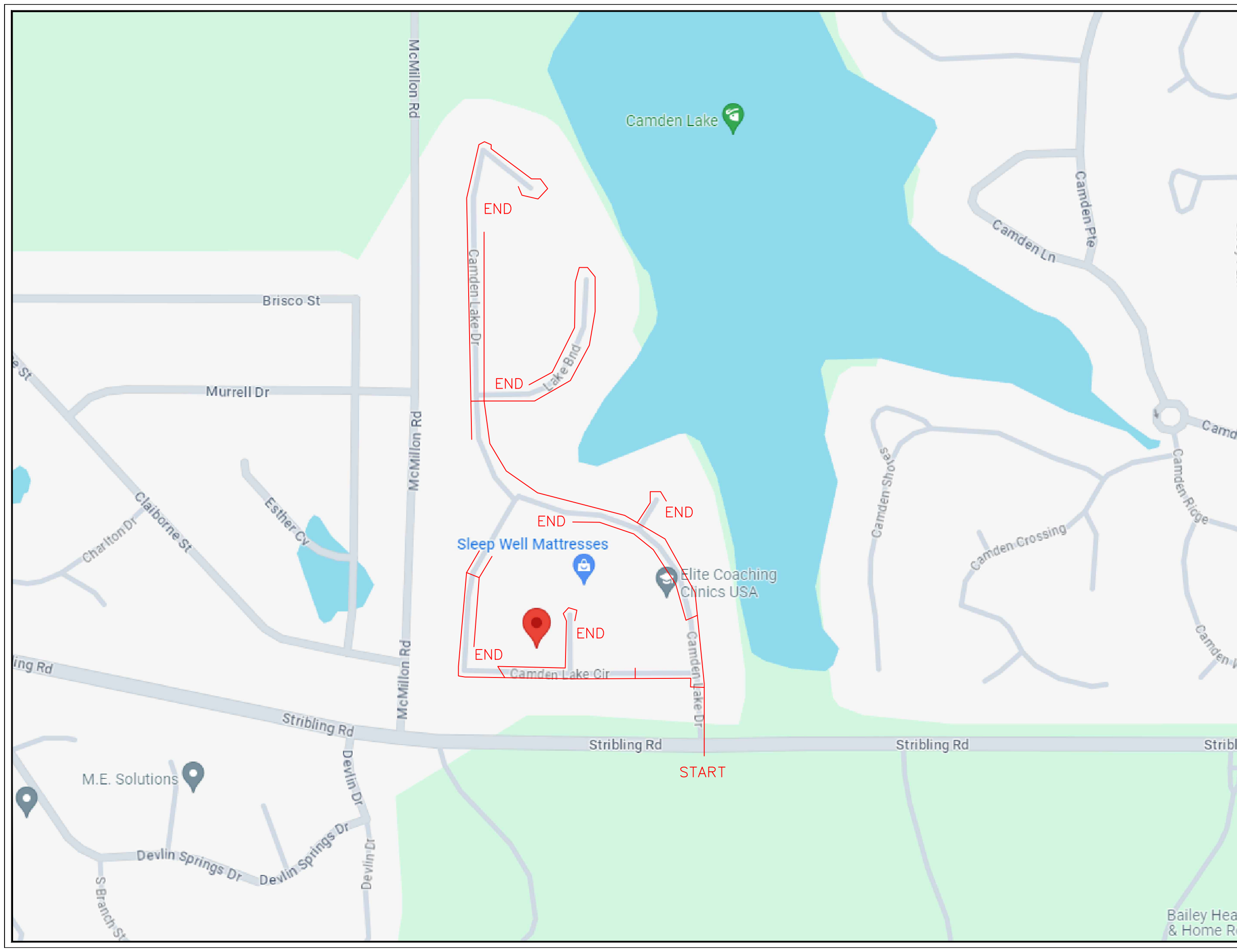



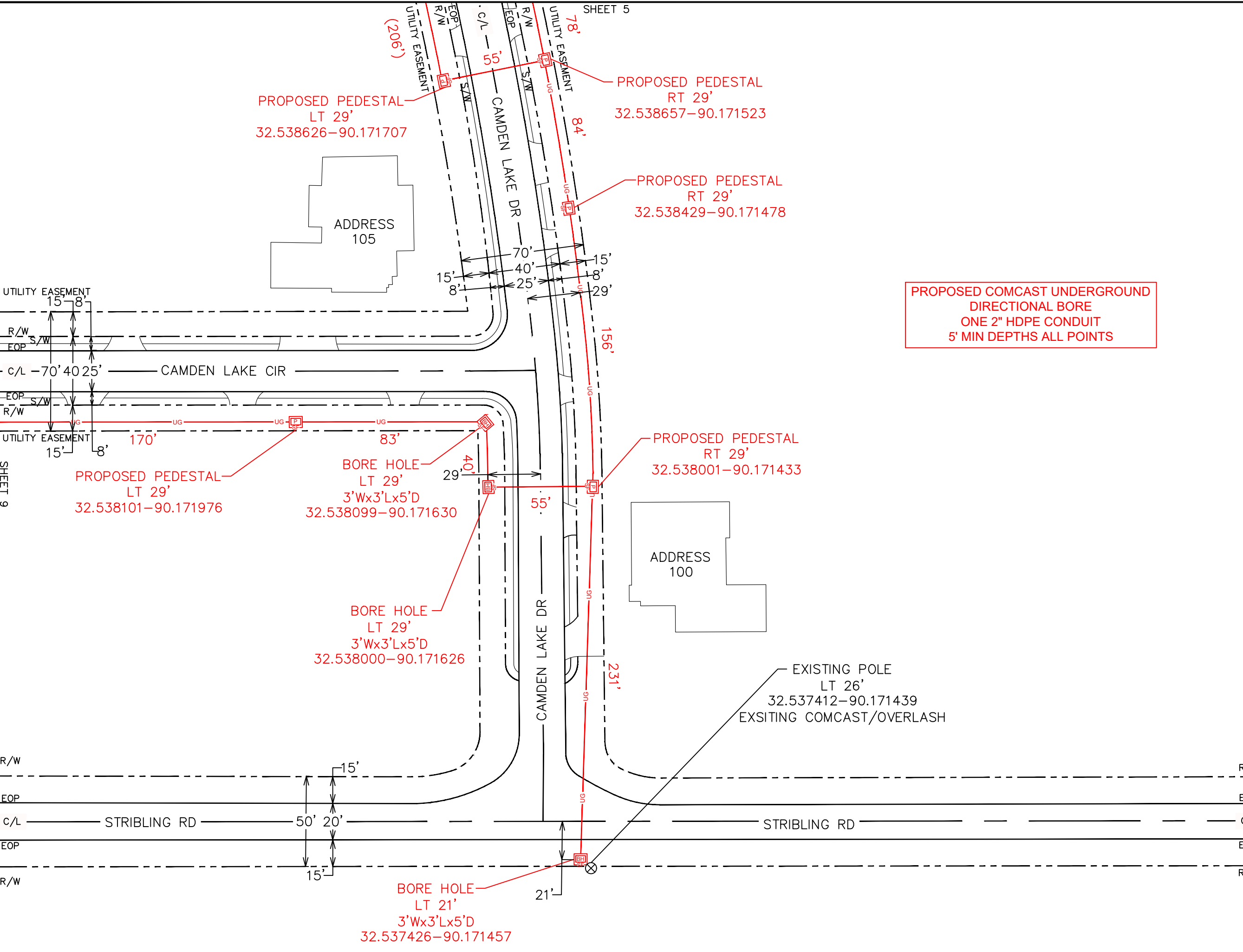

**PROPOSED COMCAST UNDERGROUND  
DIRECTIONAL BORE  
ONE 2" HDPE CONDUIT  
5' MIN DEPTHS ALL POINTS**

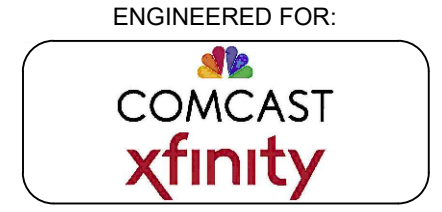

**DISCLAIMER**  
THESE DRAWINGS AND SPECIFICATIONS  
BEING ISSUED IN STRICT  
CONFIDENCE AND SHALL NOT BE  
REPRODUCED,  
COPIED, OR USED FOR ANY PURPOSE  
WITHOUT SPECIFIC WRITTEN PERMISSION

PROJECT TOTAL FOOTAGES	
NEW AERIAL BUILD	0'
NEW OVERLASH	0
NEW BURIED	8799'



MATERIAL LIST	
DESCRIPTION	QUANTITY

**PROJECT IDENTIFICATION**

JB #: JB0001399337  
 ADDRESS: 102 CAMDEN LAKE CIR  
 CITY, STATE, ZIP: MADISON MS 39110  
 COUNTY: MADISON  
 DATE: 12/19/23  
 REVISION: 0





ENGINEERED FOR:



DISCLAIMER

THESE DRAWINGS AND SPECIFICATIONS BEING ISSUED IN STRICT CONFIDENCE AND SHALL NOT BE REPRODUCED, COPIED, OR USED FOR ANY PURPOSE WITHOUT SPECIFIC WRITTEN PERMISSION

PROJECT TOTAL FOOTAGES

NEW AERIAL BUILD	0'
NEW OVERLASH	0
NEW BURIED	8799'



MATERIAL LIST

DESCRIPTION	QUANTITY

PROJECT IDENTIFICATION

JB #:	JB0001399337
ADDRESS:	102 CAMDEN LAKE CIR
CITY, STATE, ZIP:	MADISON MS 39110
COUNTY:	MADISON
DATE:	12/19/23
REVISION:	0

PROPOSED PEDESTAL  
LT 49'  
32.540050-90.172134

PROPOSED PEDESTAL  
RT 49'  
32.539891-90.171876

PROPOSED PEDESTAL  
RT 29'  
32.539752-90.172384

BORE HOLE  
RT 29'  
3'Wx3'Lx5'D  
32.539720-90.172301

PROPOSED COMCAST UNDERGROUND  
DIRECTIONAL BORE  
ONE 2" HDPE CONDUIT  
5' MIN DEPTHS ALL POINTS

PROPOSED PEDESTAL  
LT 29'  
32.539554-90.172337

PROPOSED PEDESTAL  
RT 29'  
32.539418-90.171863

PROPOSED PEDESTAL  
RT 29'  
32.539258-90.171737

PROPOSED PEDESTAL  
LT 29'  
32.539098-90.171860

PROPOSED PEDESTAL  
RT 29'  
32.538872-90.171578

SHEET 6

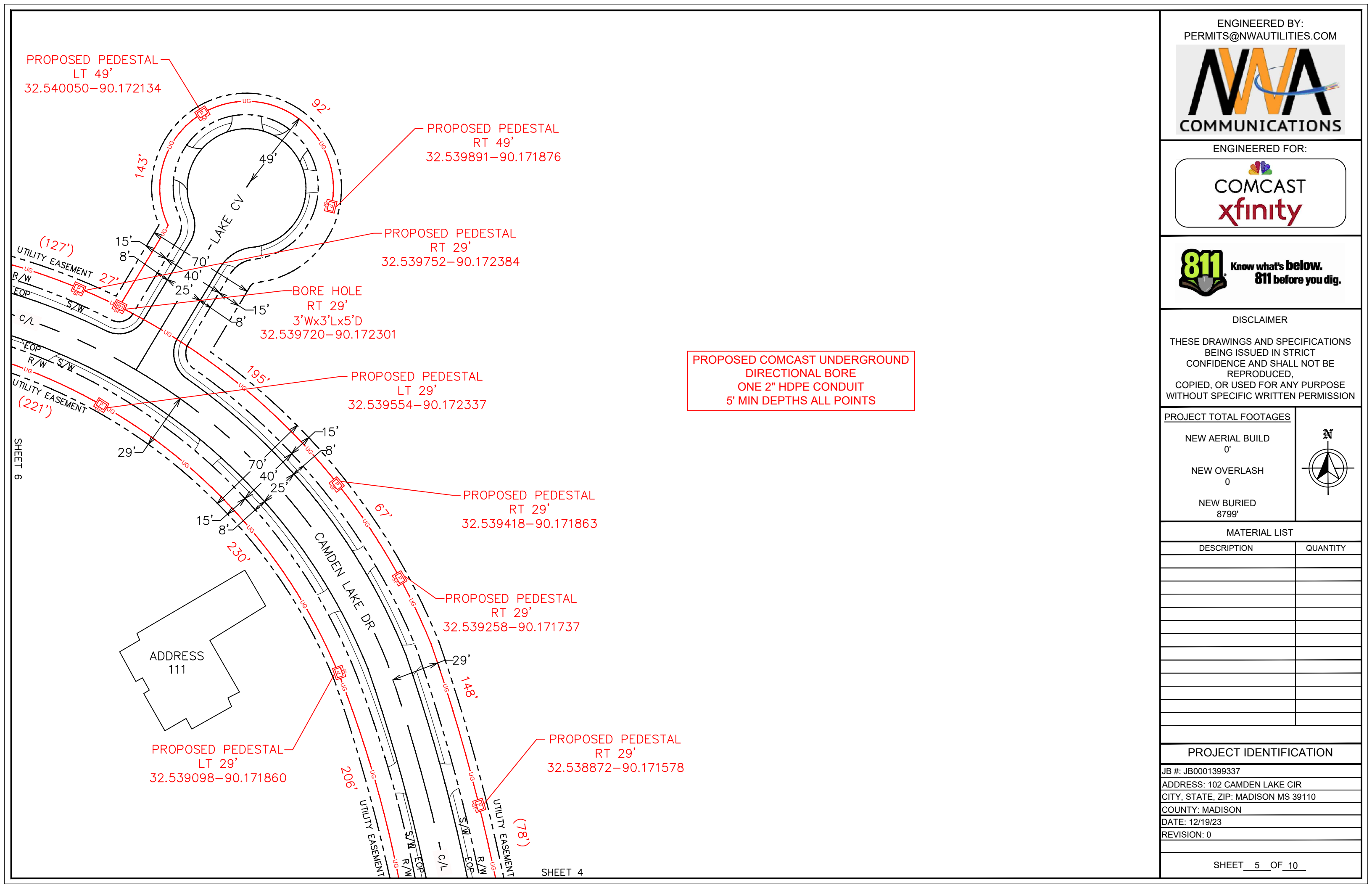







ENGINEERED FOR:



DISCLAIMER

THESE DRAWINGS AND SPECIFICATIONS BEING ISSUED IN STRICT CONFIDENCE AND SHALL NOT BE REPRODUCED, COPIED, OR USED FOR ANY PURPOSE WITHOUT SPECIFIC WRITTEN PERMISSION

PROJECT TOTAL FOOTAGES

NEW AERIAL BUILD	0'
NEW OVERLASH	0
NEW BURIED	8799'

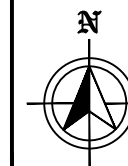

MATERIAL LIST

DESCRIPTION	QUANTITY

PROJECT IDENTIFICATION

JB #: JB0001399337
ADDRESS: 102 CAMDEN LAKE CIR
CITY, STATE, ZIP: MADISON MS 39110
COUNTY: MADISON
DATE: 12/19/23
REVISION: 0



ADDRESS  
155

PROPOSED PEDESTAL  
LT 67'  
32.543442-90.173969

PROPOSED COMCAST UNDERGROUND  
DIRECTIONAL BORE  
ONE 2" HDPE CONDUIT  
5' MIN DEPTHS ALL POINTS

PROPOSED PEDESTAL  
LT 67'  
32.543348-90.174206

PROPOSED PEDESTAL  
LT 29'  
32.543272-90.173815

PROPOSED PEDESTAL  
LT 29'  
32.543143-90.174234

PROPOSED PEDESTAL  
LT 55'  
32.543081-90.173367

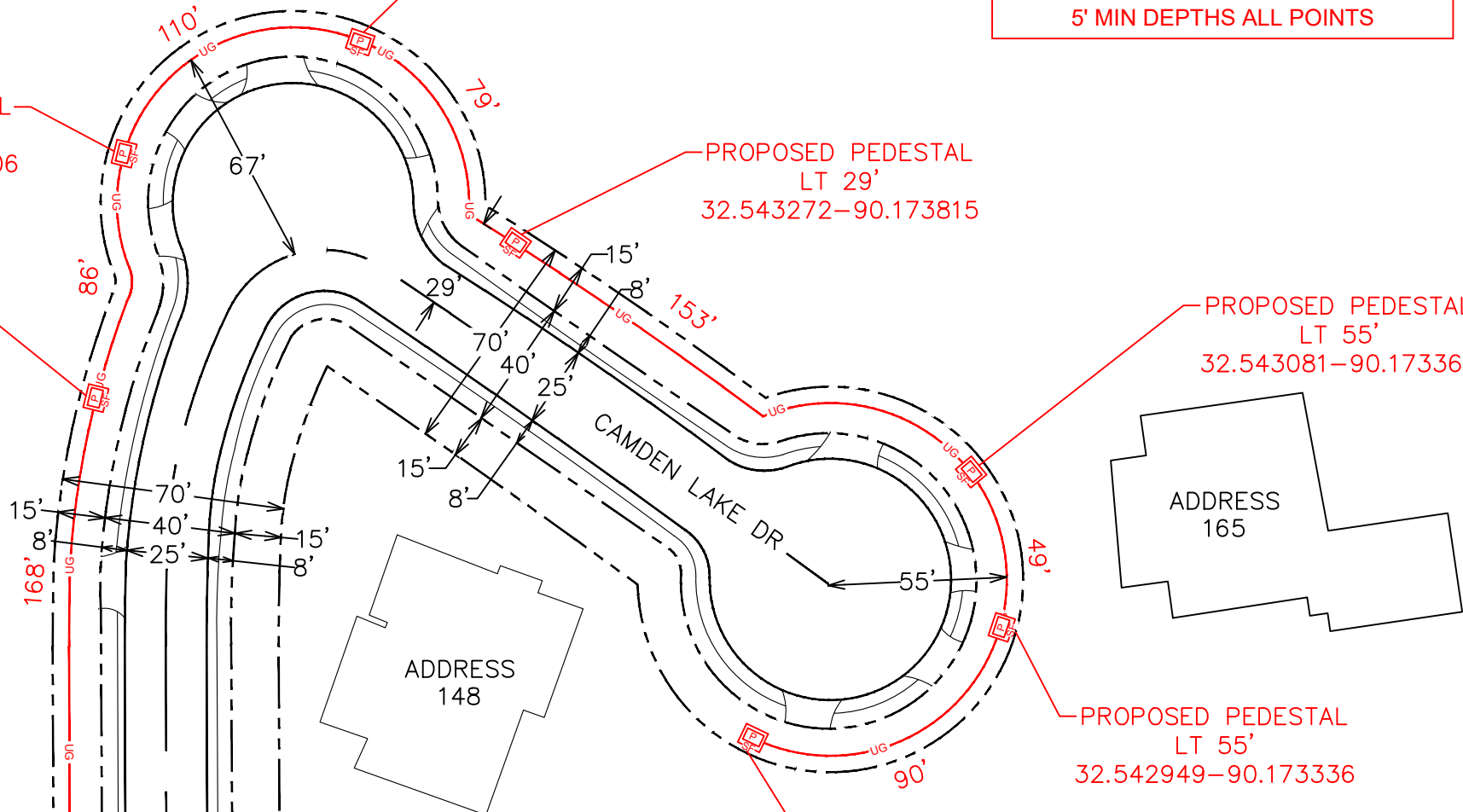

ADDRESS  
165

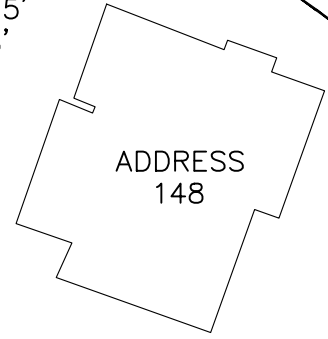

ADDRESS  
148

PROPOSED PEDESTAL  
LT 29'  
32.542678-90.174258

PROPOSED PEDESTAL  
RT 29'  
32.542773-90.174065

PROPOSED PEDESTAL  
RT 55'  
32.542857-90.173581

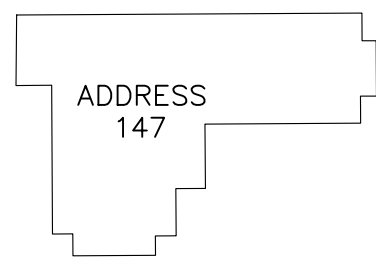

ADDRESS  
147

PROPOSED PEDESTAL  
LT 29'  
32.542431-90.174259

PROPOSED PEDESTAL  
RT 29'  
32.542297-90.174064





ENGINEERED FOR:



DISCLAIMER

THESE DRAWINGS AND SPECIFICATIONS  
BEING ISSUED IN STRICT  
CONFIDENCE AND SHALL NOT BE  
REPRODUCED,  
COPIED, OR USED FOR ANY PURPOSE  
WITHOUT SPECIFIC WRITTEN PERMISSION

PROJECT TOTAL FOOTAGES

NEW AERIAL BUILD	0'
NEW OVERLASH	0
NEW BURIED	8799'

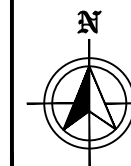

MATERIAL LIST

DESCRIPTION	QUANTITY

PROJECT IDENTIFICATION

JB #: JB0001399337  
ADDRESS: 102 CAMDEN LAKE CIR  
CITY, STATE, ZIP: MADISON MS 39110  
COUNTY: MADISON  
DATE: 12/19/23  
REVISION: 0

PROPOSED COMCAST UNDERGROUND  
DIRECTIONAL BORE  
ONE 2" HDPE CONDUIT  
5' MIN DEPTHS ALL POINTS

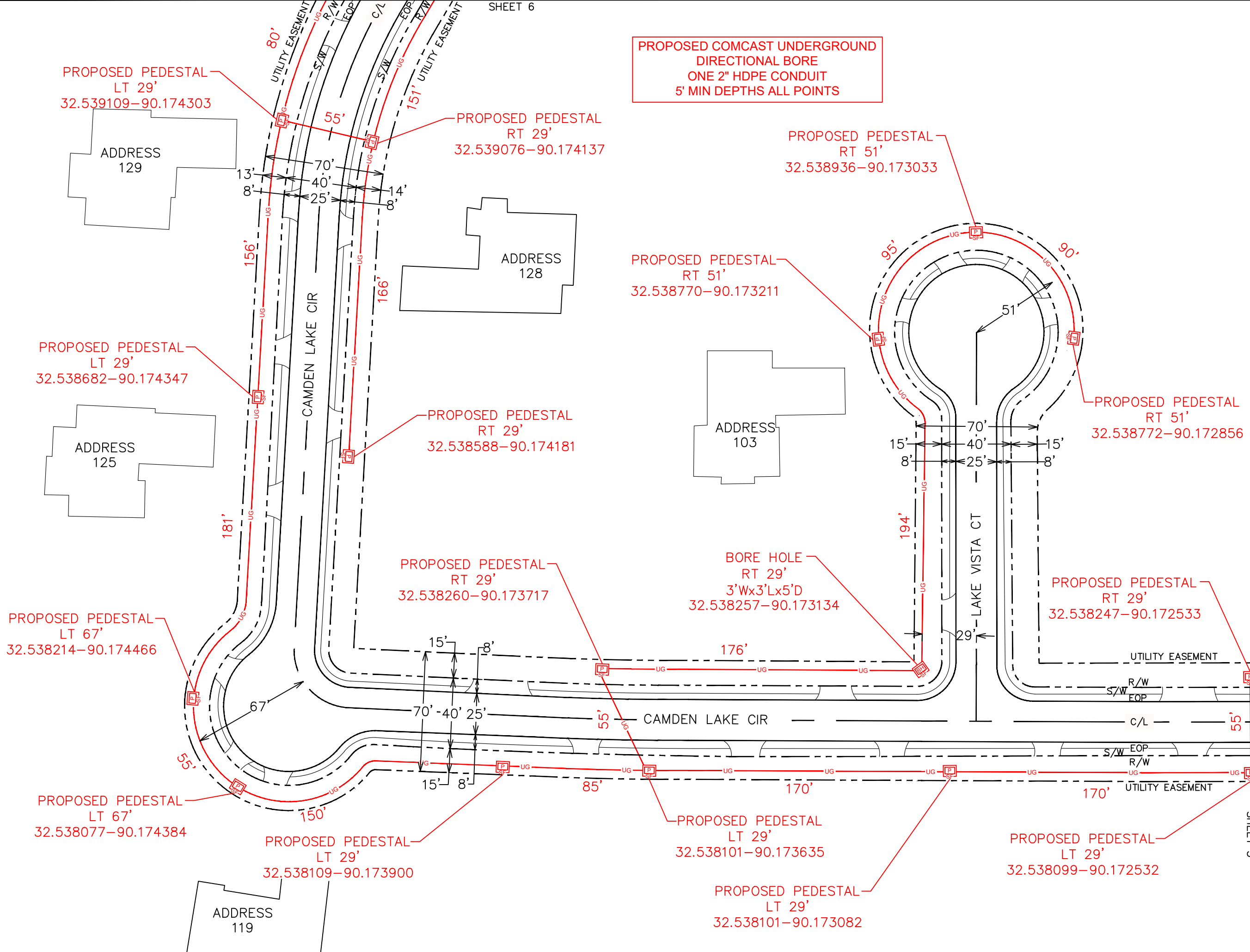

SHEET 5



ENGINEERED FOR:



**DISCLAIMER**

THESE DRAWINGS AND SPECIFICATIONS BEING ISSUED IN STRICT CONFIDENCE AND SHALL NOT BE REPRODUCED, COPIED, OR USED FOR ANY PURPOSE WITHOUT SPECIFIC WRITTEN PERMISSION

**PROJECT TOTAL FOOTAGES**

NEW AERIAL BUILD  
0'

NEW OVERLASH  
0'

NEW BURIED  
8799'



**MATERIAL LIST**

DESCRIPTION	QUANTITY

**PROJECT IDENTIFICATION**

JB #: JB0001399337

ADDRESS: 102 CAMDEN LAKE CIR

CITY, STATE, ZIP: MADISON MS 39110

COUNTY: MADISON

DATE: 12/19/23

REVISION: 0

**STATE HWY  
TYPICAL AERIAL  
HEIGHT**

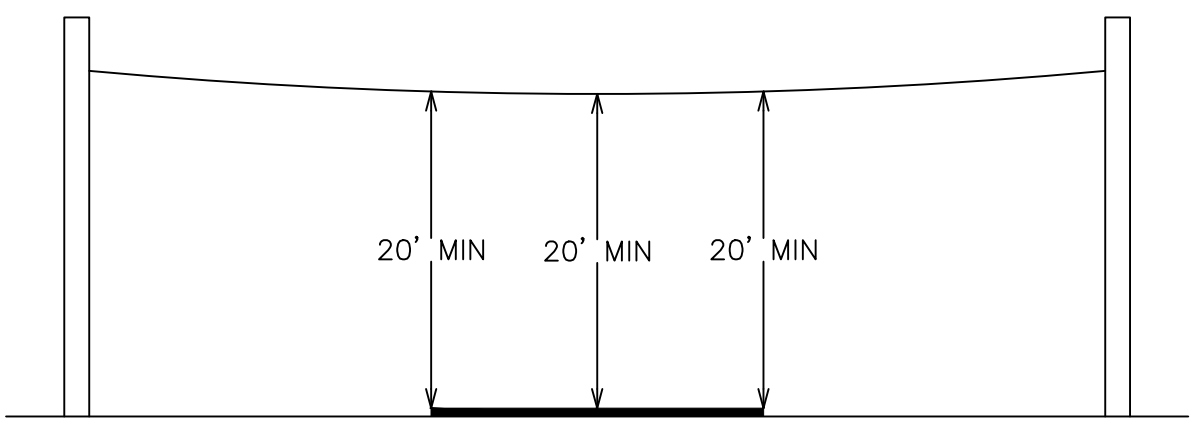

**INTERSTATE  
TYPICAL AERIAL  
HEIGHT**

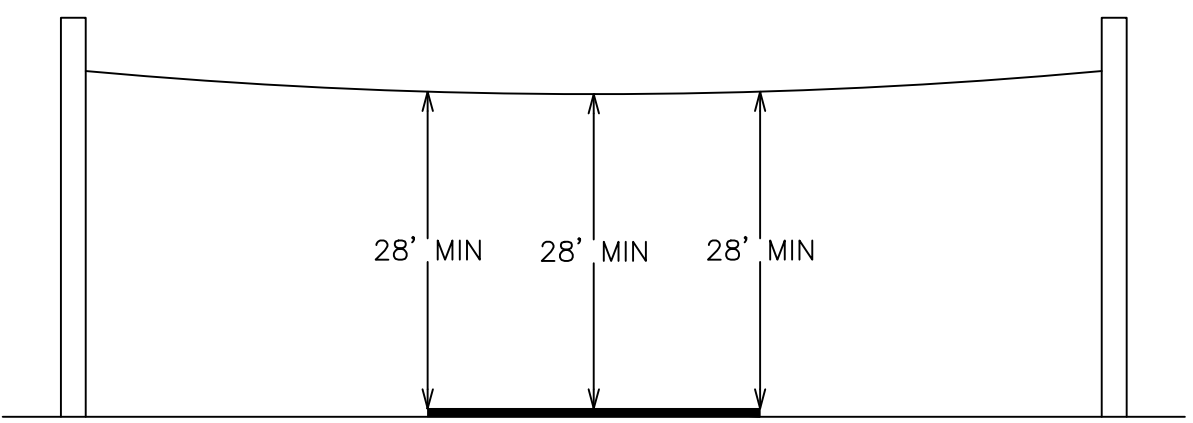

**TYPICAL UNDERGROUND  
DEPTH**

